

1 Double Dome



2 Compressive Column Arch



3 Triangulated Climber

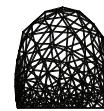

4 Box Dome



5 Parabolic Vault



6 Triangulated Prism

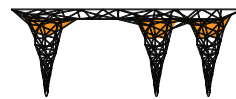

7 Three Legged Plane

PROJECT

FUTURE LUNCH PARTY

TYPE

COMMISSIONED INSTALLATION

LOCATION

WOODLAND HILLS, CA

DATE

2011

The proposition to augment the highly constructed and orchestrated landscapes within Woodland Hills' idyllic grounds is answered through a temporary presence of instigation. A diffused composition, challenging the site by revealing latent forces and natural systems, the collection works collaboratively and individually address discrete environmental factors. Seven pavilions, each constructed out of 1/2" variably triangulated galvanized conduit, array across the site. Independently stabilized, structurally optimized, they set as forms defined by the relationship of material to force. A simple but clean bolted connection allows for material optimization through a streamlined morphology. Their reflective surface makes them bounce and dissolve with light. Their geometry regulates their presence but doubles with their shadow. Object and field are equalized through the density of their frame. The installation works as individual elements and a collective composition. They are experienced and discovered through time, assembled through memory and engaged through the primal senses. The touch of the tickling arch; the temperature of the three legged shadow; the wind of the vaulting spire; the colored light and time of the transitional dome; the event of the three legged feeder; the rest and ornamental objectification of the stair lounge; and the reflective perception of the water prism. They are each about experience of one's place understood through the bodily perception of oneself.



BORDEN PARTNERSHIP

1918 LAUDERDALE STREET
HOUSTON, TEXAS 77030

www.bordenpartnership.com

1

**(1) Double Dome**

[Three Legged Shade Structure]

Straddling the southern entry bridge, the three legged double dome hovers in the heat. Bouncing from railing to railing to railing, the variably triangulated galvanized conduit dome produces a double shell. Select panels are infilled to provide shade and respite on the exposed cross-road. The shape implies pause along a circuit of motion. The cool shade makes one linger. Your arrival has been announced. Your presence and surroundings are one. For a brief moment you recognize sun and shade, place and body. You have arrived at yourself.

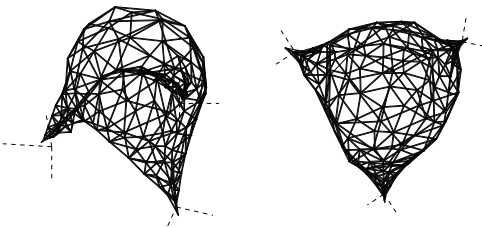

2

**(2) Compressive Column Arch**

[Tickler]

Announcing entry and welcoming you every morning the compressive arch spans from column to column. Pinching and balancing above your head it drips fluorescent cords from each of its nodes. As a light veil, one penetrates, getting hugged and tickled and massaged. Once through you turn to say goodbye and look forward to your next encounter. The shape and effect make you aware of your body and happy with the role of being in a tactile world.

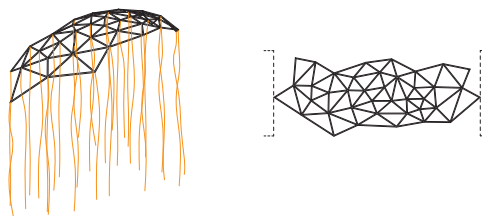

(3) Triangulated Climber [Stair Bench Planter]

Taking the stair that hugs the west tower, the terraced increment of the ascending steps is marked with movement and rest. Cresting stair and landing, stair and landing. One reaches a threshold, body fatigued. The climber waits and reaches out to greet you. Holding a plank of Douglas fir, it beckons you sit. Pause for a moment. Rest and relax. As you begin to survey your surroundings you realize you are not the only thing being held. You look to your right and see a delicate flower. Cupped, held, ascended, the flower looks back at you. Together you sit in harmony in your quite companionship.

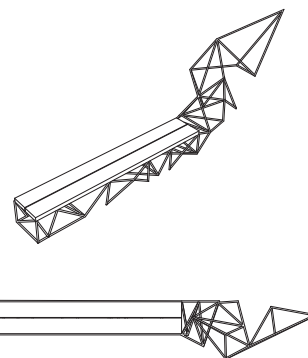
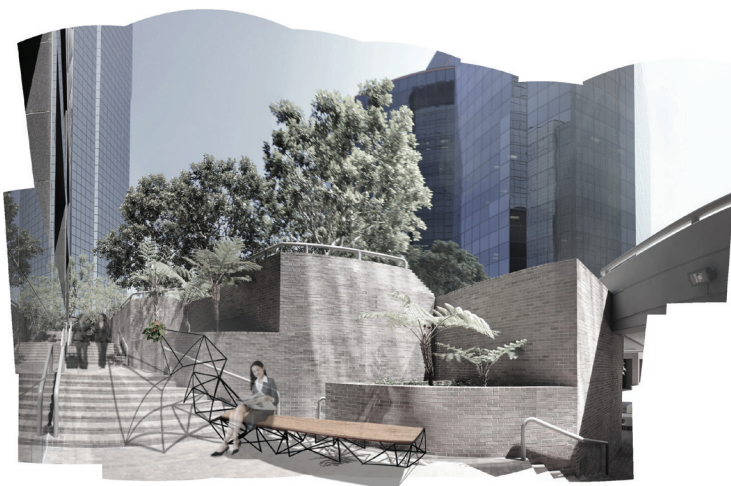

(4) Box Dome [Water Light Sundial]

Spanning the headwater fountain, a square to circle to dome structure frames and cages the water's source. Infilled with twelve clusters of orange Plexiglas panels, each faceted node is activated as the sun moves. Marking the hours of the day, the chromic projections move across the water and ground noting time and place. The chronology of being is revealed through the visualization of moment. Time calibrates place and the ritual of this precise moment are positioned within the broader range of time. The water light dome allows for the positioning of the now within the broader then.

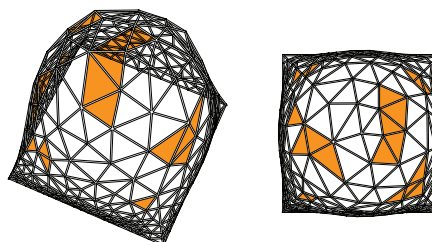
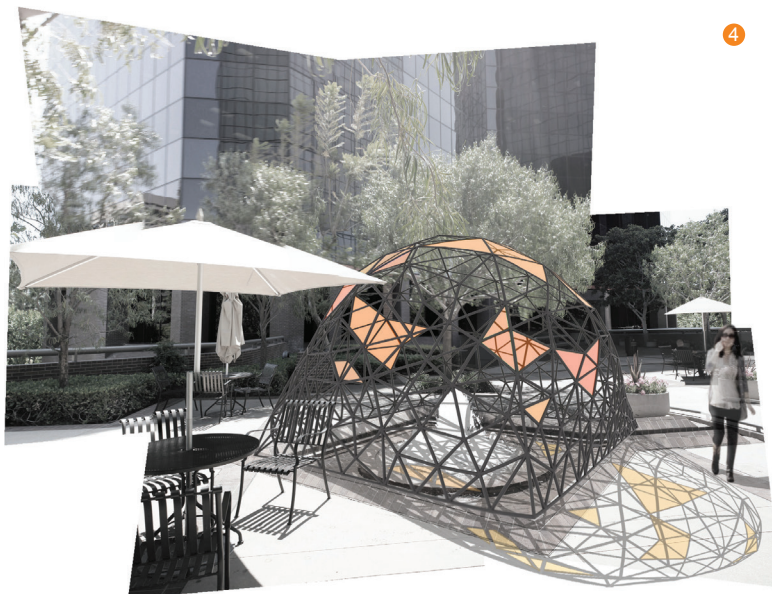

FUTURE LUNCH PARTY

5

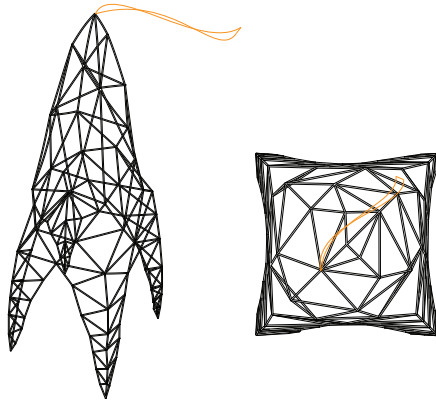
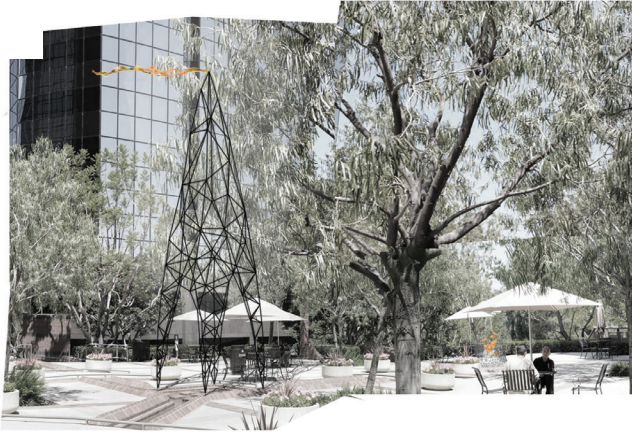

(5) Parabolic Vault [Wind Spire]

Located above the central crossing of the forking river in the elevated courtyard, the wind spire is the highest element in the reflective crystal canyon of the three surrounding towers. Central, slender and dominant, the tower spans the water. It rises to hold fluorescent orange ribbons. Their fluttering in the wind registers motion and air. The movement demarcates the place's animated being. The surrounding ether, ever present yet never noticed, moves. Its direction is known, its presence is announced. The here is made here.

6

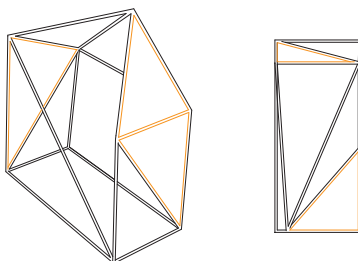
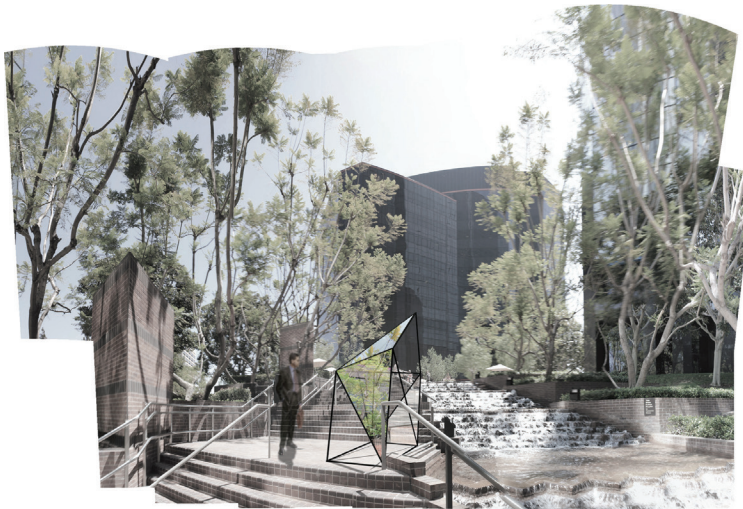

(6) Triangulated Prism [Reflective Light Water]

The variable triangulation standard to each of the other pieces regularizes here to creates a balanced figure. Set in the dynamic presence of the cascading waterfalls, the geometric body holds a foiled contrast. Three mirrored panels, each uniquely set on an x, y or z axis bounce the movement of the water, the body and the surrounding landscape. Catching a glimpse of one another they infinitely reverberate between the faces of their spatial leaks. The figure, set along the monumental stair, is seen from above during the descent and from below during the ascent. The ever changing nature reflects and responds to the action and event of place, time and space all relative to our perception.

(7) Three Legged Plane [Bird Feeder]

Nestled in the knoll, across the shallow waters of the fountains arrival, sits a three legged structure. Expanding from the ground like ham hock legs up to a flat table, each connective joint holds a cupped vessel. Full of bird seed, they flutter with life. Birds dive and wait, borough and hope. Their chirping conversation is intoxicating. The energy and density make a crowd of life and action. You eat lunch at the umbrella covered table and watch the birds eat. The birds eat at their cupped vessels and watch the people eat. The quite communion of the collective biology of food to energy, animation to interaction, and the life of place to the life of the self is palpable. Our bodies demand the event. Our primal commonality binds our being.

